

H-Baffle I Color 444 (Gray)

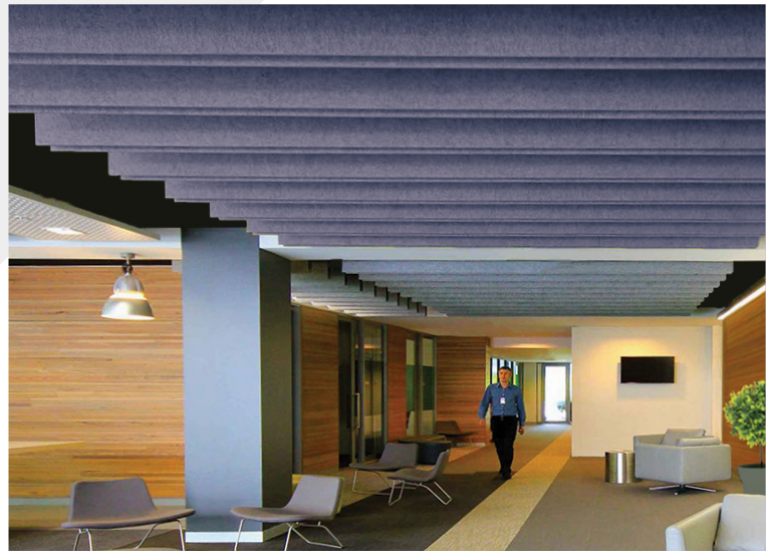

H-Baffle I Color 276 (Lavender)

	Metric	Standard	Width	Weight	LF/Unit
40" Length	1016mm x 229mm	40 in. x 9 in.	84mm	4.5 lbs	3.3
48" Length	1219mm x 229mm	48 in. x 9 in.	84mm	5 lbs	4
72" Length	1829mm x 229mm	72 in. x 9 in.	84mm	8 lbs	6
96" Length	2438mm x 229mm	96 in. x 9 in.	84mm	10 lbs	8

All specs refer to singular products and not multiples unless specified. Custom options available upon request.

H-Baffle

The EchoPanel® H-Baffle is designed to look great while dispersing and absorbing excessive noise. The H-Baffle can be ceiling hung at any height using cable or rod. Hang EchoPanel H-Baffles in regular rows or random groupings to create wayfinding or other visual design solutions. Custom configurations available.

NRC (SOUND ABSORPTION RATING): ASTM C423-90A

Standard EchoPanel® NRC acoustic data is available for acoustic calculations. Please contact Kirei for this test data.

Fire Rating

ASTM E84 Class C (Class A treatment available.)

VOC Emissions

CDPH (CA 01350) Compliant; TVOC: <0.5 mg/m3
 Ecospecifier GreenTag Compliant;
 TVOC: 0.015 mg/m2/hr (ASTM D5116)



H-Baffle I Color 444 (Gray)

Available Solid Colors



Hardware & Installation

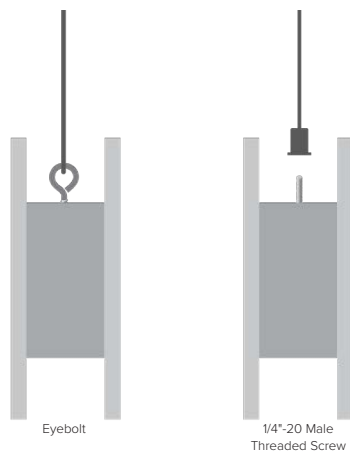

Mounting Hardware Options

Hanging Hardware

H-Baffles have two attachment points with a 1/4"-20 female thread and come with your choice of eyebolts or 1/4"-20 male threaded screw hardware.

To install H-Baffles, attach the specified ceiling mounting hardware and suspension cable/chain/rod/etc. with the appropriate connector at the bottom end. Once the ceiling hardware is installed, attach the connector to the supplied attachment hardware on the H-Baffle.

Note: Kirei does not provide ceiling mounting hardware or cable/chain/rod.