

EchoTile Wave Installation Guide

Note: Please read the entire Installation Guide before application.

The installation guide is intended to provide installers with helpful information regarding EchoTile Wave prior to installing the material. Kirei accepts no responsibility for installation actions taken or not taken. This installation guide is not intended to be an in-depth guide; installers' knowledge as experienced tradesman needs to be applied.

This installation guide serves only as a recommendation for installing and handling EchoTile Wave. If you have questions about application or techniques, contact Kirei at www.kireiusa.com or 619.236.9924.

ECHOPANEL SPECIFICATIONS

What is EchoTile Wave?

EchoTile Wave is made from EchoPanel®, a decorative surface material offering acoustic performance with a felt-like finish. It is made from 100% PET thermally stable plastic which, contains at least 60% post-consumer content. EchoPanel is also recyclable in the PET waste stream. Please consult the EchoTile Wave spec sheet for material specifications.

Fire Rating

ASTM E84 Class A

Low VOC Material

EchoPanel is considered a low-VOC emitting material making it a healthy building option for interior finishes. EchoPanel is CDPH (CA 01350) Compliant TVOC: <0.5 mg/m³, and Ecospecifier GreenTag Compliant; TVOC: 0.015 MG/M²/HR (ASTM D5516).

Handling and Storage

Keep it clean! EchoPanel is an absorbent material and traps dirt, grime and debris just as well as it does sound. White glove handling is recommended for prep, processing and installation. Kirei is not responsible for mishandling on the job site.

Keep it flat! If cutting, drilling or mounting hardware on site, make sure that EchoTile Wave is evenly supported on a flat, clean surface. Improperly handled material can crease.

Storage areas should be clean, dry, cool, and well ventilated.

EchoTile Wave Installation Guide

Handling and Storage (Cont.)

All EchoTile Wave products are inspected prior to shipment. Kirei is not responsible for damage in shipment or in storage; customers should carefully inspect all items at time of delivery and note any obvious damage on the delivery receipt. For the customer's protection subsequently discovered concealed damage must be reported immediately to the carrier. Claims to Kirei will not be considered if the sheet has been worked by the customer or others. No claims for labor charges will be allowed in any circumstances.

To handle and store EchoTile Wave properly, follow these guidelines:

- Carefully inspect all material at time of delivery and note any obvious damage on the delivery receipt.
- Keep EchoTile Wave as clean as possible during storage. EchoTile Wave should be kept free from grease, wax, dust, and chips that could leave impression.
- Store EchoTile Wave indoors, in a dry, cool, well-ventilated area.
- Avoid exposure to heat 150°F (65°C) or greater.
- Keep table tops clean to avoid scratching.
- Inspect for defects, then recover for protection during fabrication.
- Wear clean white gloves when handling EchoTile Wave.
- Do NOT store EchoTile Wave near radiators, steam pipes, or in direct sunlight.

Cleaning and Care

Remove dust and dirt by dusting, vacuuming, or with a soft cloth or sponge and a solution of carpet or upholstery shampoo. Always use a soft, damp cloth and blot dry. Spot cleaner such as ZEP Commercial Instant Spot Remover has been used with success for some light soil situations. No guarantee is given for cleaning results with this product.

Contents of One EchoTile Wave Box

- (9) Wave Tiles
- (4) Clip A
- (8) Clip B
- (4) Clip C
- *16 total clips, which are appropriate for a 3 x 3 tile configuration*

EchoTile Wave Installation Guide

Installation

1. Mark out the desired clip pattern. The pattern shown is based on a 19.7 in. x 19.7 in. grid. *Please note, this pattern can also be rotated 90 degrees for a landscape layout.*
2. Choose either nails or screws to suit wall construction. You may want to use double sided

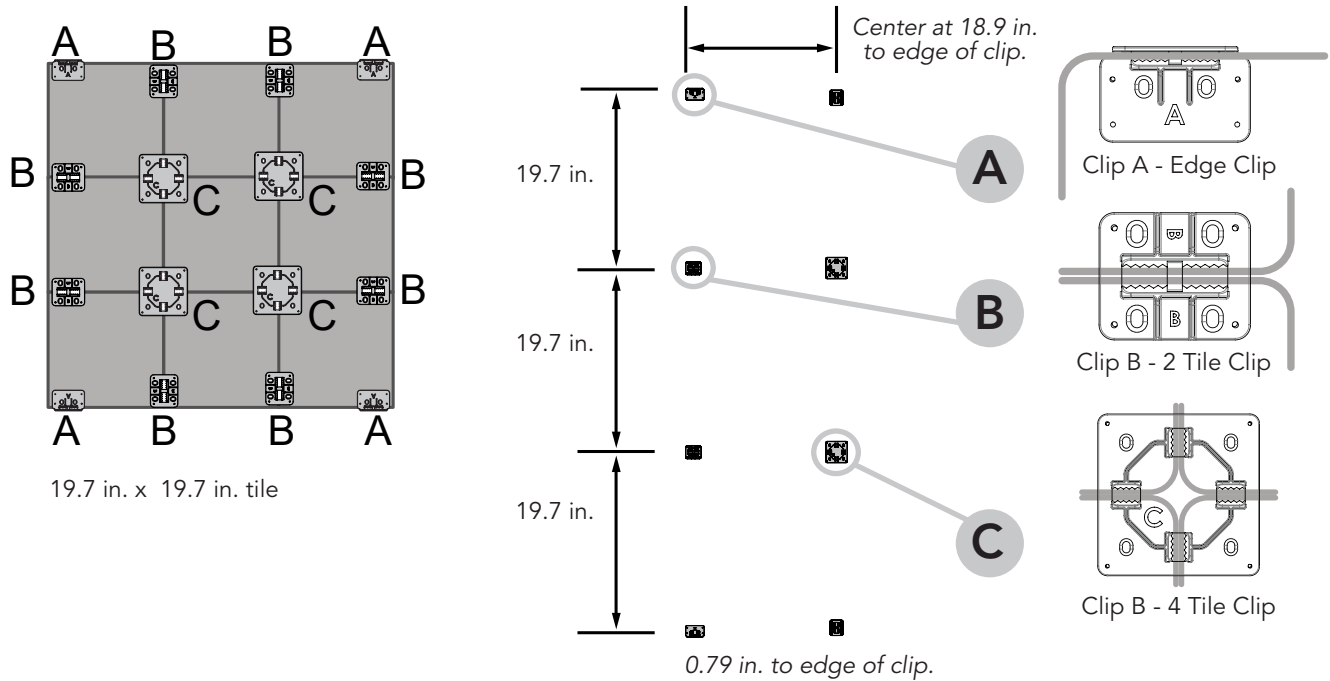

tape to temporarily hold the clips while installing them. If using nails, it is critical that they are inserted at an angle.

3. When all the clips are fixed you will have a grid of clips ready to install the tiles.

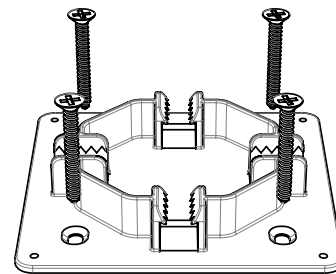
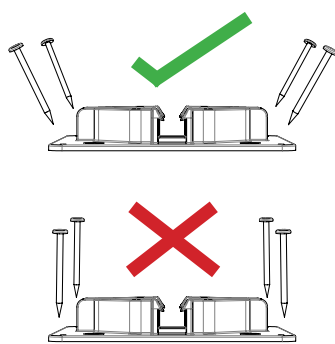
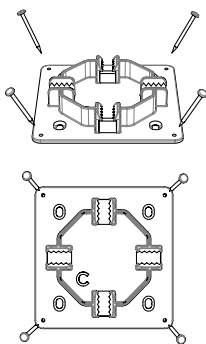

Screws may require additional fixing accessories like wall plugs for masonry.

EchoTile Wave Installation Guide

- Align tiles in clips before pushing them into position. *Please note, Tiles are difficult to remove once installed.*
- The clips supplied are appropriate for the installation of 9 tiles arranged in a 3 x 3 grid. The

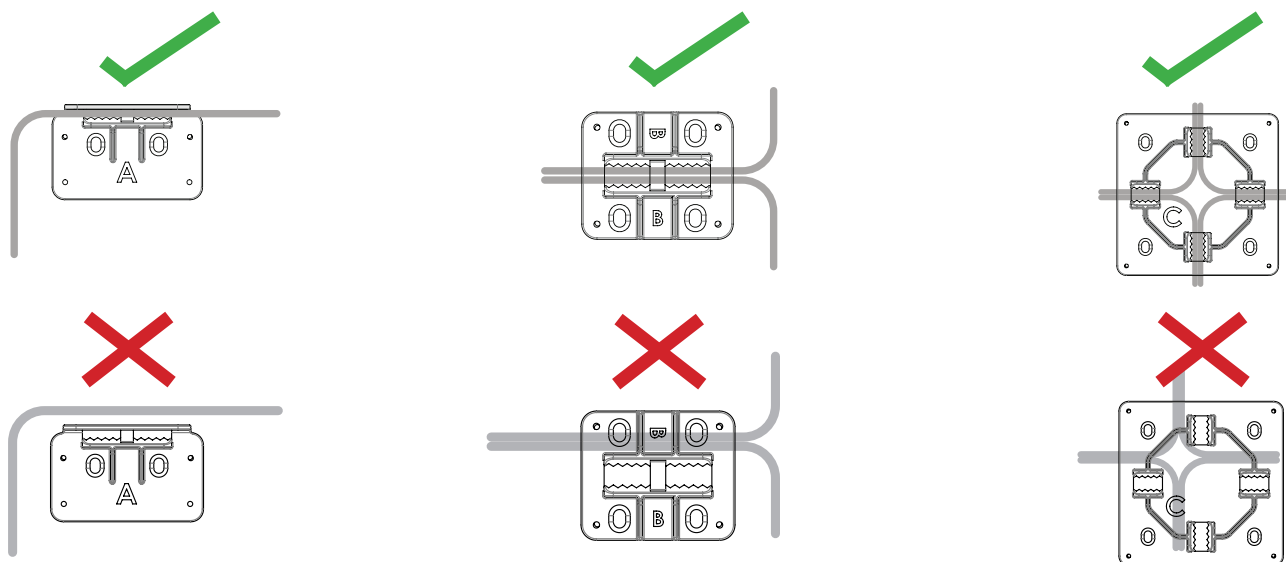

arrangement as shown, can be achieved with 3 boxes of 27 tiles. Other layouts will require extra clips. Additional clips are available in packs of 10 of A, B, C, or 16 mixed clips.

All tiles need a clip at each corner. Use Edge Clip (A) for any perimeter corner (as shown). Use 2 Tile Clip (B) where tiles meet (as shown). Use 4 Tile Clip (C) where 4 tiles intersect (as shown).

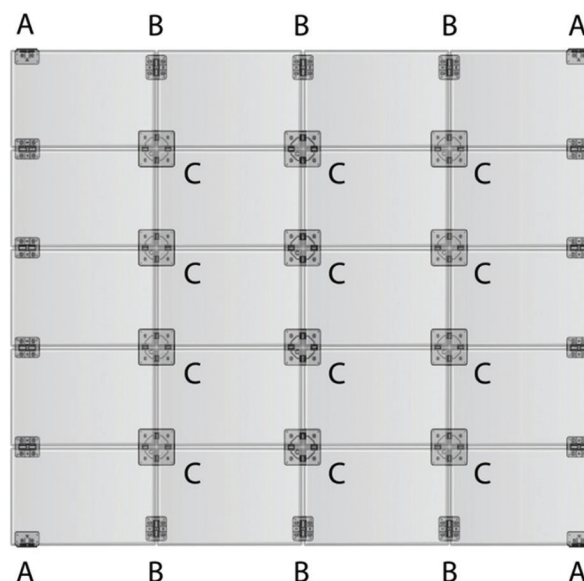

Work Safety

In the interest of work safety, it is recommended that people working with EchoTile Wave wear the appropriate safety equipment. Although the product emits zero off-gases, masks and

EchoTile Wave Installation Guide

gloves should be worn to ensure the maximum possible safety precautions. For an SDS form, please contact Kirei at info@kireiusa.com or 619-236-9924.

Final Note

Kirei will not be responsible for any cutting or mounting not performed by Kirei staff.

For any other questions or concerns, please contact Kirei.