

# AKUART Hang With Me Installation Guide

*Note: Please read the entire Installation Guide before application.*

The installation guide is intended to provide installers with helpful information regarding AKUART Hang With Me prior to installing the material. Kirei accepts no responsibility for installation actions taken or not taken. This installation guide is not intended to be an in-depth guide; installers' knowledge as experienced tradesman needs to be applied.

This installation guide serves only as a recommendation for installing and handling AKUART Hang With Me. If you have questions about application or techniques, contact Kirei at [www.kireiusa.com](http://www.kireiusa.com) or 619.236.9924.

## AKUART HANG WITH ME SPECIFICATIONS

What is AKUART Hang With Me?

AKUART Hang With Me are suspended acoustic panels, with an easily changeable canvas. Made from sustainable materials, these superior sound absorbers deliver high NRC, well balanced sound absorption. The canvas is washable and bleach-cleanable and can be printed on with high-resolution images and graphics as art, wayfinding, and interior accents. Please consult the AKUART Hang With Me Spec Sheet for material specifications.

### Fire Rating

AKUART Hang With Me Canvas: Classification B-s1 according to DIN EN 13501-1.

AKUART Hang With Me Acoustic Material: Fire retardant. Classification: B-s1, d0 according to EN ISO 11925-2 & EN 13823.

### Environmental Certificates

VOC Emissions: CDPH v1.2-2017 Compliant; TVOC <0.5 mg/m<sup>3</sup>

OEKO-TEX® Standard 100

### Product Care

AKUART is made with a form-stable stretched fabric which does not wrinkle or fold when mounted on the frame.

The panel can withstand daily dusting, vacuum cleaning and a weekly wiping with a wet cloth without the use of chemicals. The AKUART canvas is easily cleanable with bleach and can be machine washed at high temperatures (194 F), making it an ideal solution for pathogen concerns and healthcare environments.

# AKUART Hang With Me Installation Guide

AKUART's unique design makes it possible to quickly and easily detach and replace the canvas, providing the option to change and update the print.

## Installation

Due to the great variance in over head environments, our guidelines are meant to provide suggested placement only. Exact placement and suspension methods are subject to design specification, regional code, site-specific requirements, and installer judgment.

## Components Included

1. Top Wires - Used to attach the top row of panels to the ceiling mounts. Two per column.
2. Connector Wires - Two for each middle and bottom row frames.
3. Ceiling Mounts - Used to attach the top row of panels to the ceiling. Two per column.
4. Hang With Me Frame - Comes with four wire locks pre-installed. Two in top, two in bottom.
5. Floor Attachment Kit (optional):
  - A. Floor Wires - Used to attach bottom row of panels to floor mounts. Two per column.
  - B. Floor Mounts - Used to attach bottom row of SmartDividers to floor. Two per column.

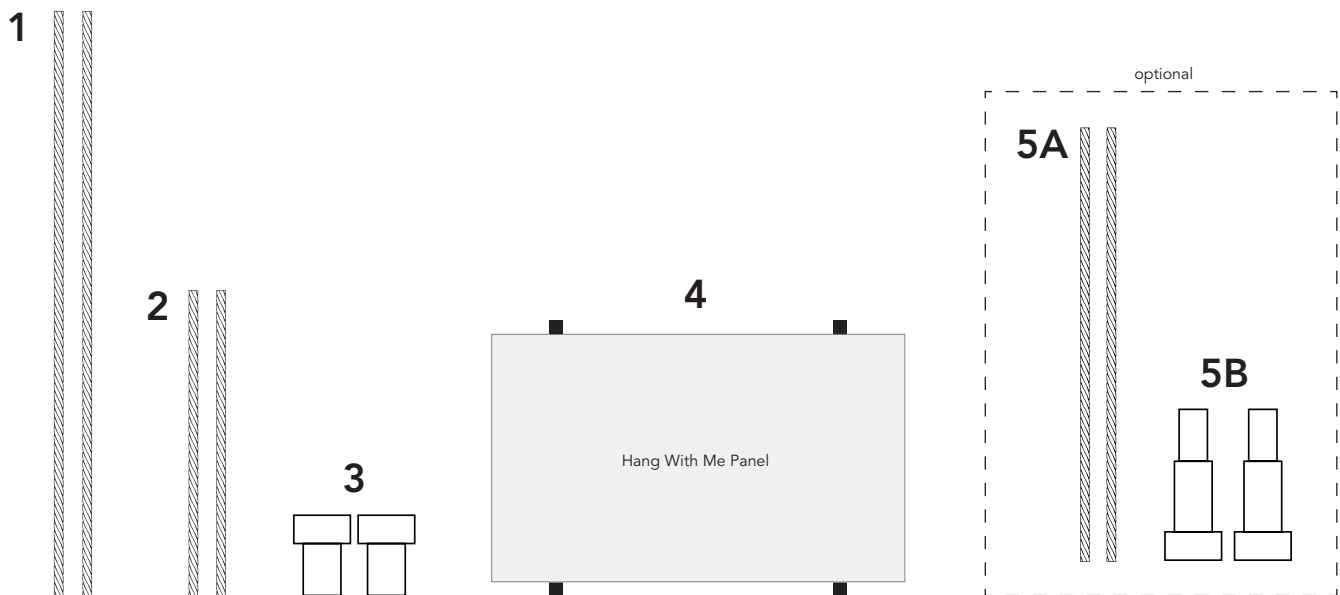

# AKUART Hang With Me Installation Guide

## Tools Needed (not included)

1. Screws - Body diameter max 5 mm. Must be appropriate size for rawl size.
2. Power Drill - Drill bit must be appropriate size for rawl size.
3. Wire Cutters - For trimming excess wire.
4. Rawl Plugs - Two needed per column. Must be appropriate size for screws. Must be appropriate for ceiling material.
5. Laser Level (optional) - Helps with alignment of frames and drilled holes.

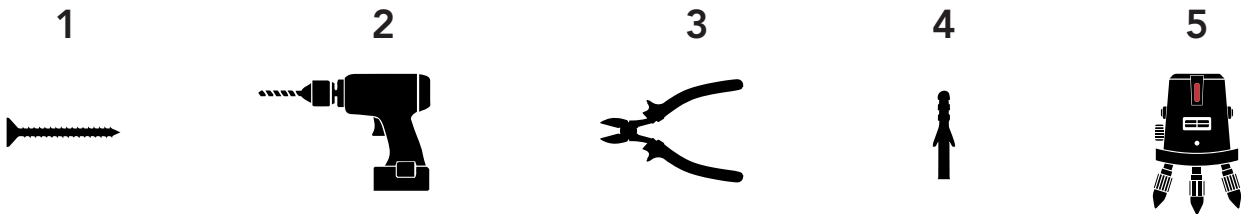

## Assembly of Top Wires and Ceiling Mounts

For each top wire supplied, attach the ceiling mount as illustrated below.

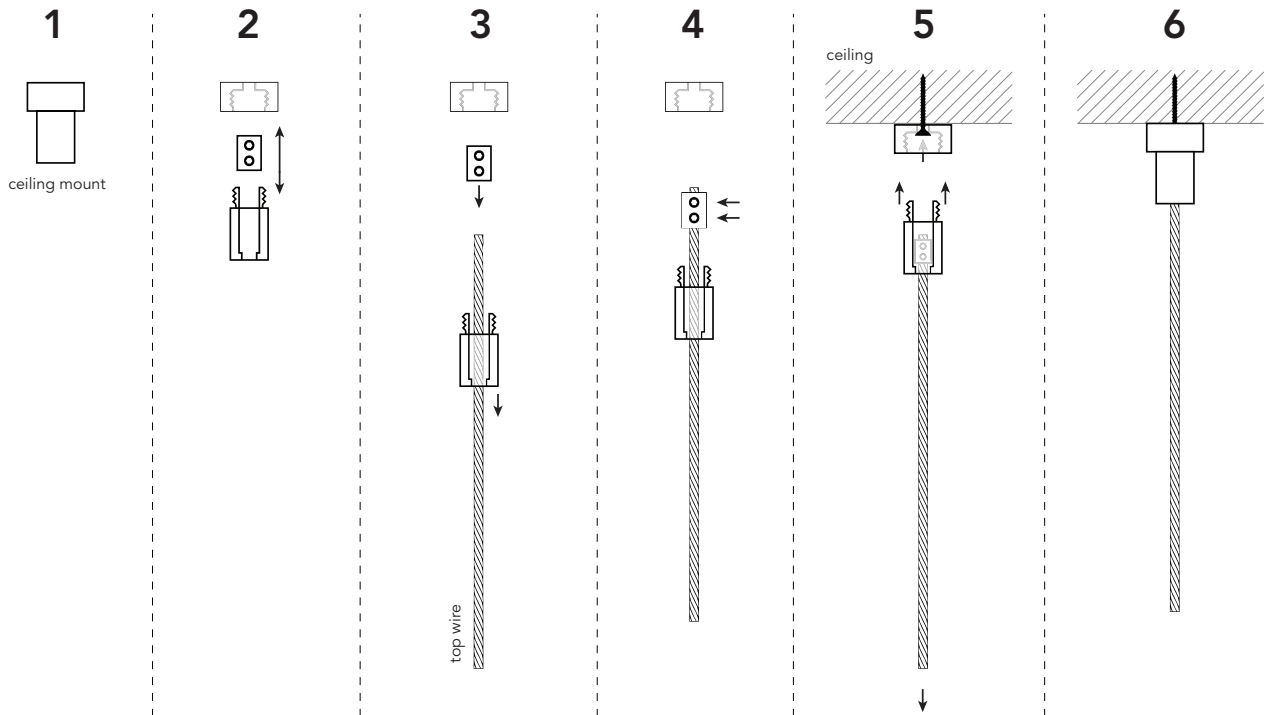

# AKUART Hang With Me Installation Guide

## Installation of Top Wires

1. Drill holes in ceiling, add rawl plugs.
2. For each row of suspended panels, the distance between the two holes is 19.29 in. Once ceiling hardware is securely mounted carefully lay out, install, and level the baffles.
3. The distance between the last hole for a given row and the first hole of the next row is 7.10 in.
4. Screw ceiling mounts with attached top wires into holes in ceiling.
5. The distance between two rows of suspended panels is 2 in.
6. Insert the ends of the top wires into the wire locks on the panels. Depress the wire lock to release the wire again.
7. The top wires can be trimmed to the desired length from ceiling to the top of the panels, plus an additional 2 in, using wire cutters. Do this before inserting the wires into the wire locks.

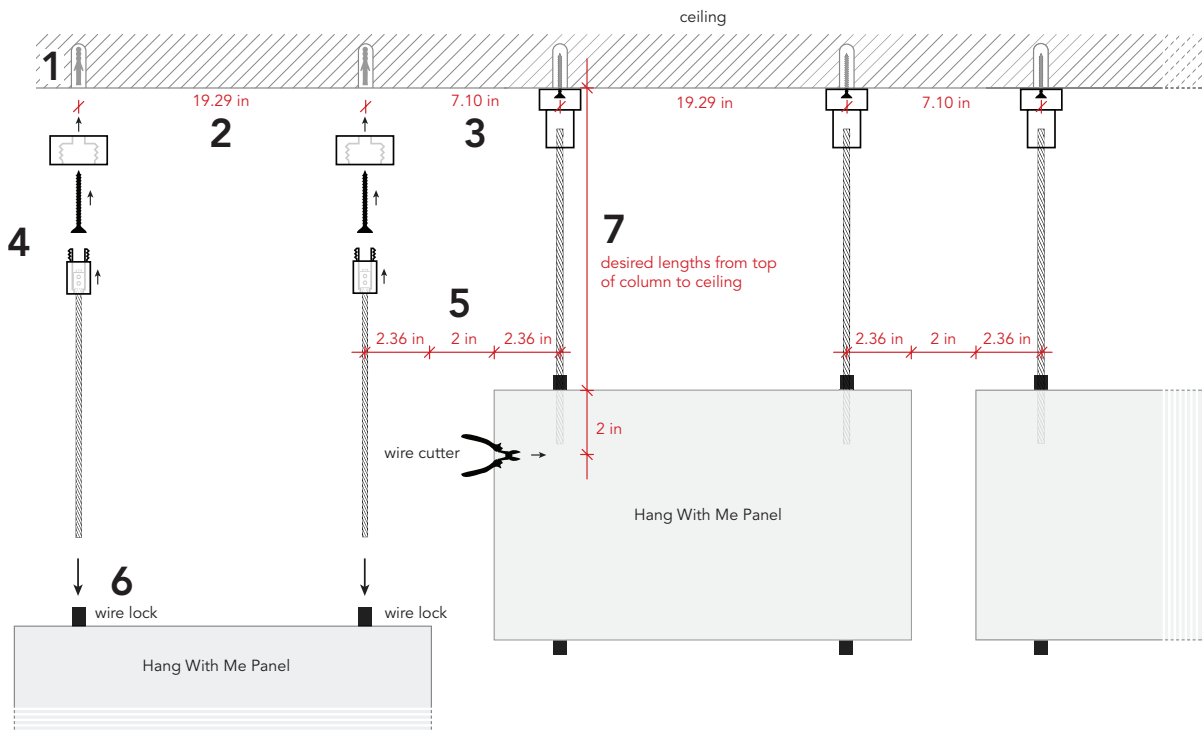

# AKUART Hang With Me Installation Guide

## Installation of Additional Rows

1. Use the short connector wires to connect each row to the next as needed.
2. The distance between each row of SmartDividers is 2 in, the same as the distance between each column.
3. To adjust the distance between two Hang With Me panels, either push the wire further into the wire lock, or depress the wire lock until it releases the wire.

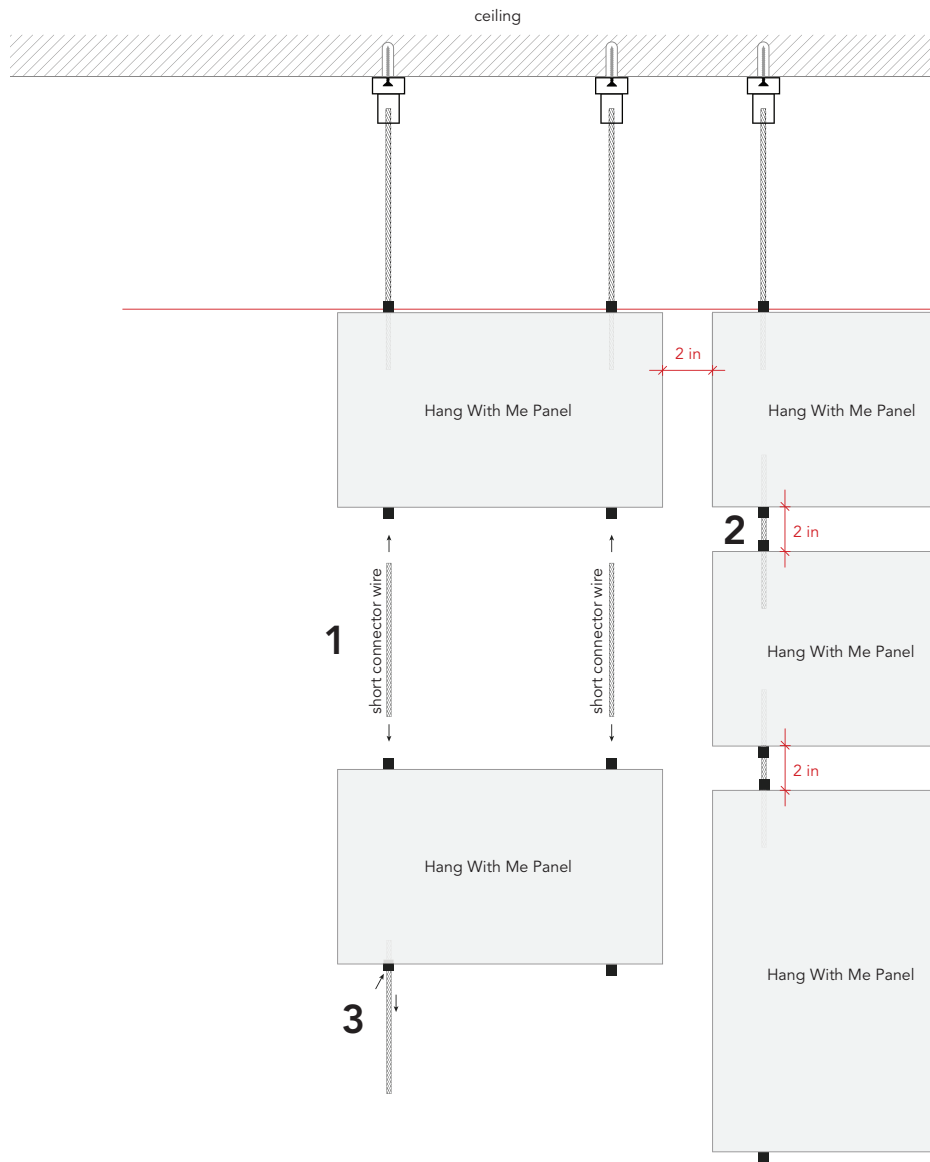

# AKUART Hang With Me Installation Guide

## **Work Safety**

In the interest of work safety, it is recommended that people working with AKUART Hang With Me wear the appropriate safety equipment. Although the product emits zero off-gases, masks and gloves should be worn to ensure the maximum possible safety precautions. For an SDS form, please contact Kirei at [info@kireiusa.com](mailto:info@kireiusa.com) or 619-236-9924.

## **Final Note**

Kirei will not be responsible for any cutting or mounting not performed by Kirei staff.

**For any other questions or concerns, please contact Kirei.**