



EchoSky Installation Guide

Note: Please read the entire Installation Guide before application.

The installation guide is intended to provide installers with helpful information regarding EchoSky prior to installing the material. Kirei accepts no responsibility for installation actions taken or not taken. This installation guide is not intended to be an in-depth guide; installer's knowledge as an experienced tradesman needs to be applied.

This installation guide serves only as a recommendation for installing and handling EchoSky. If you have questions about application or techniques, contact Kirei at www.kireiusa.com or 619.236.9924.

Parts Included

- The EchoSky Acoustic Baffle System is composed of 3 primary elements: the Aluminum Tube Rack, our proprietary Aluminum Channel Track and the EchoPanel Baffles.
- The rack can be hung using aircraft cable, chain or rod as specified by the client. Both the Channel Track and Rack are engineered for compatibility with standard 1/4"-20 fasteners, and the suspension system can be attached to both the Channel Track and/or the Rack.
- EchoSky comes with both 1/4"-20 Eyebolts for hanging with looped cable or chain as well as 1/4"-20 x 3/4" Set Screws which are compatible with most aircraft cable suspension hardware.

Recommended Tools

- Rubber Mallet (clean, non-marring white or natural preferred)
- Drill/Screw Gun
- 1/8" Hex Driver for Set Screws | 4mm Hex Driver for Joint Connector Bolts

Preferred Assembly

The safest and easiest assembly is achieved by supporting the Rack at a comfortable working height with room to mount the Channel Track and Baffles at or near its installation location. Two-person assembly is suggested for larger EchoSky Acoustic Baffle Systems. Multiple or continuously-connected EchoSky Racks are best assembled by completely assembling the frame on a protected floor surface and suspending it prior to mounting Channel Tracks and Baffles.

Installation

Due to the great variance in overhead environments, our guidelines are meant to provide suggested placement only. Exact placement and suspension methods are subject to design specification, regional code, site-specific requirements, and installer judgment.

Based on specifics of location height, type of mounting hardware and available equipment, the installer may pre-assemble the Rack at ground level with only 2 or 3 Channel Tracks and hanging hardware pre-mounted, and complete the assembly of remaining components while suspended.

Note: Installers are responsible for supplying the 3/64" - 1/16" aircraft cable and the code compliant ceiling mounting hardware. Kirei does not provide ceiling mounting hardware or cable/chain/rod.

Rack and Channel Track

1. Lay out the Tube Frame on a clean, protective surface with the holes facing up.
2. Using a white rubber mallet, drive the Tube Connectors fully into the tube ends. Be sure to protect the tube from hard surfaces and denting during assembly.
3. Place Channel Track underneath the frame, slide in hex nuts for assembly (add 2 extra and slide towards center for the Channel Track positions that are to be used for suspending the EchoSky.)
4. Insert Joint Connector Bolt, align to Nut and hand thread. Using a hex driver, tighten while maintaining the Frame and Channel Track aligned properly.
5. Repeat steps for all Channel Tracks.
6. Position the extra Hex Nuts and thread in Eyebolt or Set Screw for connecting to the specified suspension system.



Step 1



Step 2



Step 3



Step 4

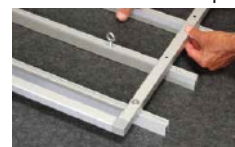

Step 5



Step 6

Channel Track and Baffle

7. Align with 3" of baffle extending from end of Channel Track.
8. Place screw in pre-drilled hole of Channel Track and fasten.
9. Complete Channel Track/Baffle set is now ready to mount on rack.



Step 1

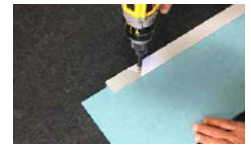

Step 2

Hanging Options

- 24" x 48" and 48" x 48" rack systems can be hung with four attachment points.
- 24" x 96" and 48" x 96" rack systems require 6-8 attachment points.
- EchoSky must be hung with weight distributed evenly between all attachment points.

Work Safety

In the interest of work safety, it is recommended that people working with EchoSky wear the appropriate safety equipment. Although the product emits zero off-gases, masks and gloves should be worn to ensure the maximum possible safety precautions. For an SDS form, please contact Kirei at info@kireiusa.com or 619-236-9924.

Final Note

Kirei will not be responsible for any cutting or mounting not performed by Kirei staff.

For any other questions or concerns, please contact Kirei.